

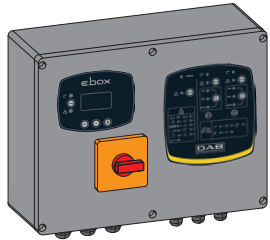

## QUICK GUIDE

### Booster Kiwa

with sensor



EG.05/15 - 60172359

**UK DAB PUMPS LTD.**  
Units 4 & 5, Stortford Hall Industrial Park,  
Dunmow Road, Bishop's Stortford, Herts  
CM23 5EZ - UK  
salesuk@dwtgroup.com  
Tel.: +44 1279 652 776  
Fax: +44 1279 657 727

**BE DAB PUMPS B.V.**  
Brusselastraat 150  
B-1702 Groen-Bijgaarden - Belgium  
info.belgium@dwtgroup.com  
Tel.: +32 2 4668353  
Fax: +32 2 4669218

**USA PUMPS AMERICA, INC. DAB PUMPS DIVISION**  
3226 Benchmark Drive  
Ladson, SC 29456 USA  
info.usa@dwtgroup.com  
Ph.: +1-843-824-6332  
Toll Free: 1-866-896-4DAB (4322)  
Fax: +1-843-797-3366

**RUS OOO DWT GROUP**  
100 bldg. 3 Dimitrova highway,  
127247 Moscow - Russia  
info.russia@dwtgroup.com  
Tel.: +7 495 739 52 50  
Fax: +7 495 465-3618

**POL DAB PUMPS POLAND SP. z.o.o.**  
Mokotow Marynarska  
Ul. Postepu 15c  
02-676 Warsaw - POLAND  
Tel.: +48 223 81 6085

**CHN DAB PUMPS CHINA**  
No.40 Kaihua Road, Qingdao Economic &  
Technological Development Zone  
Qingdao City, Shandong Province, China  
PC: 266500  
info.china@dwtgroup.com  
Tel.: +863-286812030-6270  
Fax: +863-286812210

**ESP DAB PUMPS IBERICA S.L.**  
Avenida de Castilla nr.1 Local 14  
28830 - San Fernando De Henares -  
Madrid Spain  
info.spain@dwtgroup.com  
Ph.: +34 91 6566545  
Fax: +34 91 656676

**NLD DAB PUMPS B.V.**  
Albert Einsteinweg, 4  
5151 DL Drunen - Nederland  
info.netherlands@dwtgroup.com  
Tel.: +31 416 387280  
Fax: +31 416 387299

**ZAF DWT South Africa**  
Podium at Menlyn, 3rd Floor, Unit 3001b,  
43 Ingenia Road, CIO Lois and Alterbury,  
Menlyn, Pretoria, 0181 South-Africa  
info.sa@dwtgroup.com  
Tel: +27 12 361 3997  
Fax: +27 12 361 3137

**GER DAB PUMPEN DEUTSCHLAND GmbH**  
Tackweg 11  
D - 47198 Tönisvorst - Germany  
info.germany@dwtgroup.com  
Tel.: +49 2151 82136-0  
Fax: +49 2151 82136-36

**UKR DAB UKRAINE Representative Office**  
Rugos Horizon Park  
4M, Hrinchenka St, suit 147  
03680 Kiev, UKRAINE  
Tel.: +380 44 3195943

**HUN DAB PRODUCTION HUNGARY KFT.**  
H-8500  
NAGYKANIZSA, Buda Erő u.5  
HUNGARY  
Tel.: +36.93501700



DAB PUMPS S.p.A.  
Via M. Polo, 14 - 35035 Mestrino (PD) - Italy  
Tel. +39 049 5125000 - Fax +39 049 5125950  
www.dabpumps.com

1

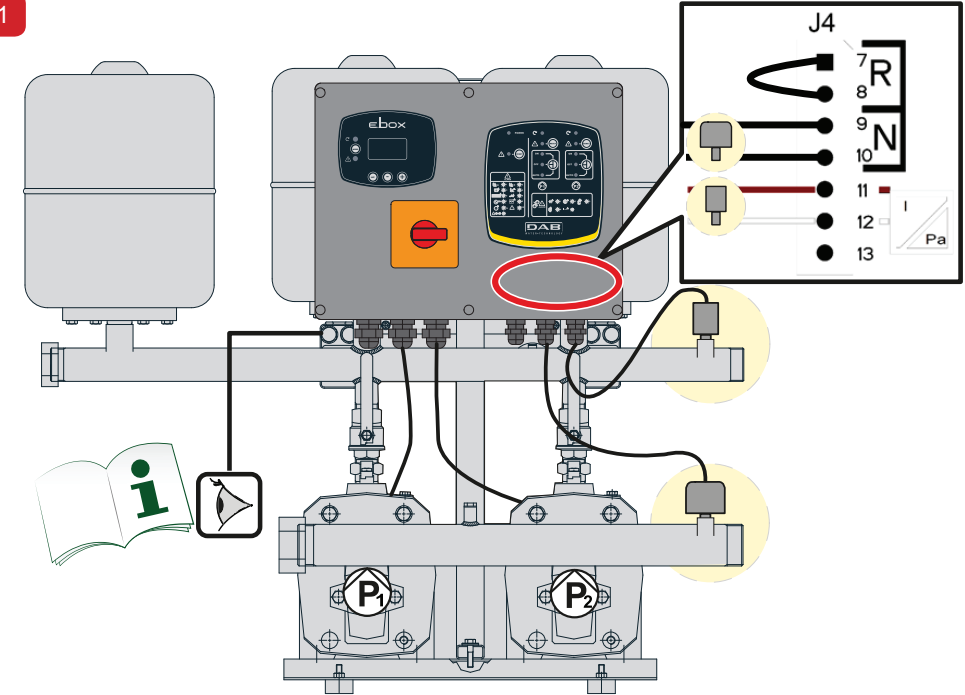

50°C Max



0°C Min



[www.dabpumps.com/qrcode/60172355\\_OM\\_EBOX.pdf](http://www.dabpumps.com/qrcode/60172355_OM_EBOX.pdf)

2

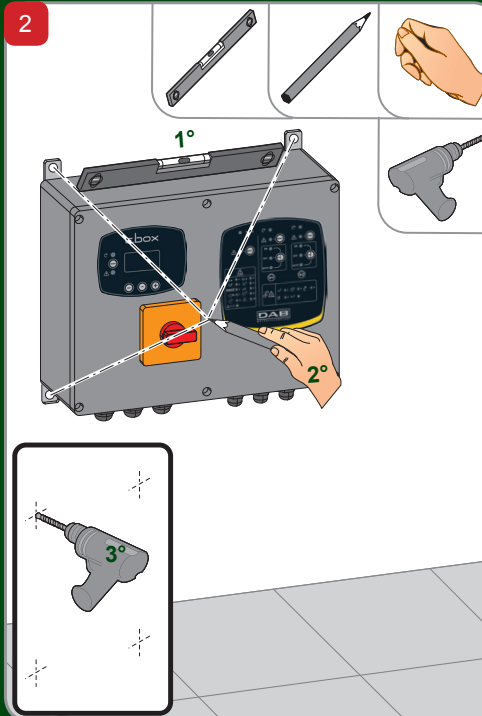

3

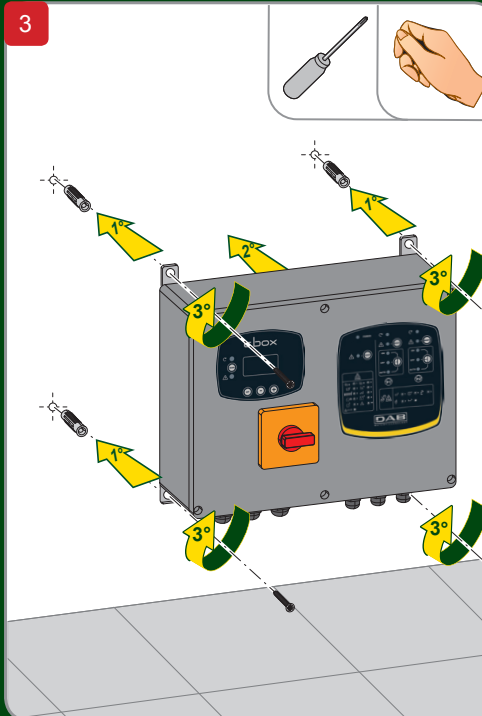

4

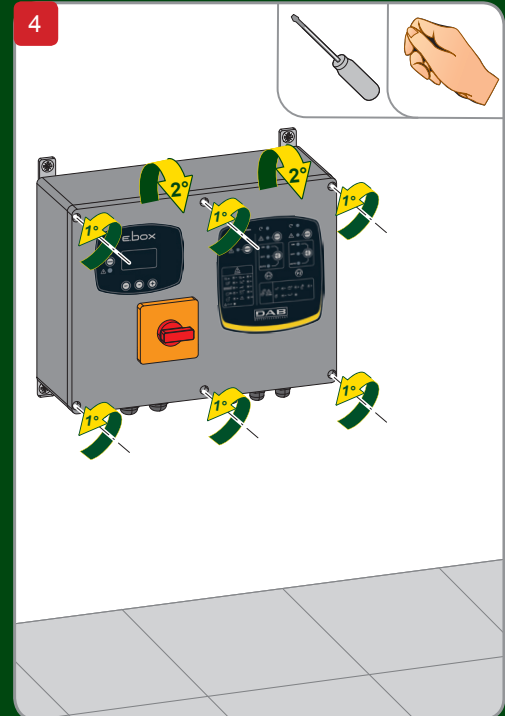

**5a** **E.Box Plus**

Wiring diagram for E.Box Plus. It shows three-phase power supply (L1, L2, L3) and neutral (N) connected to terminals. A ground connection (PE) is also shown. Two pressure sensor terminals (P1, P2) are connected to U, V, W, C, A, H, P. A warning symbol is present.

**DISPLAY**  
E.Box Plus D  
E.Box Basic D

Mechanical assembly diagram for E.Box Plus D and E.Box Basic D. It shows the display unit being inserted into the cabinet. Steps 1, 2, 3, and 4 are indicated with arrows and numbers. A warning symbol is present.

Navigation sequence for the e.box display. It shows 9 steps of menu navigation:

1. MODE button pressed.
2. LA (Teil) selected.
3. MF (Bediendruckmodus) selected.
4. MC (Druckopp. KENWA) selected.
5. MC (Druckopp. KENWA) screen with options: 4, 5, 6.
6. RC (Normaldruck) selected.
7. RC (Normaldruck) screen with options: 1, 2, 3.
8. SP (Subpunkt-druck) selected.
9. RP (Druckverschil) selected.
10. ET (Modul-wartung) selected.

The final screen shows: GELEIDE CONFIG. ET Modul-wartung. By herstarten.

**5b** **E.Box Basic**

Wiring diagram for E.Box Basic. It shows single-phase power supply (L, N) and ground (PE) connections. Two pressure sensor terminals (P1, P2) are connected to U, V, W, C, A, H, P. A warning symbol is present.

**NO DISPLAY**  
E.Box Plus  
E.Box Basic

Mechanical assembly diagram for E.Box Plus and E.Box Basic without a display. It shows the terminal block connections for DS\_A and DS\_B. DS\_A has terminals ON, KI, WA, 2s. DS\_B has terminals ON, SP, 2s, 245m, 515m. A warning symbol is present.

Mechanical assembly diagram for E.Box Plus and E.Box Basic without a display. It shows the cabinet being closed. Steps 1, 2, 3, and 4 are indicated with arrows and numbers. A warning symbol is present.

Final assembly diagram showing the E.Box unit mounted on a wall. It shows the unit with the display unit (circled in red) and the pressure sensor terminals (P1, P2) connected to the unit. A warning symbol is present.